

**Market Street  
Canton, MI  
19,305 SF  
BUILD TO SUIT**

# **FOR LEASE**

## **Building B**

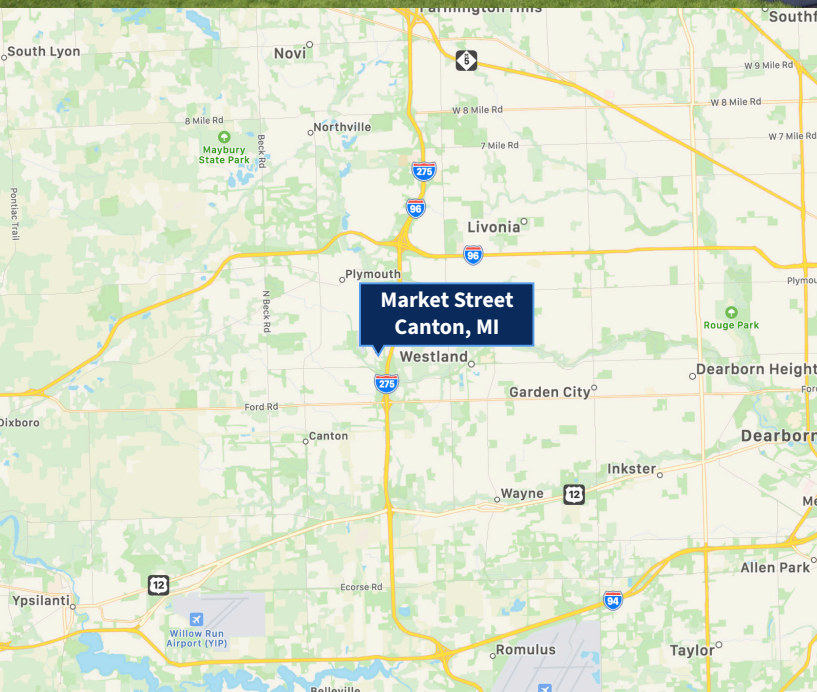

## **Property Highlights**

- 19,305 SF - BUILD TO SUIT
- Zoned Light Industrial
- 1 Dock
- 1 - 12'x14' OHD
- 21.5' Clear Ceiling Height
- 480 - 3 Phase Power
- 400 - 1000 AMPS
- Utilities Ready
- Ample Parking
- 1 Mile from Ann Arbor Rd Exit & I-275
- 1.25 Miles from Ford Rd. Exit & I-275
- Market Street Industrial Park - 4 buildings

For more information, please contact:

**BEN CRABILL III**  
(313) 720-0990

[ben3@crabillandcompany.com](mailto:ben3@crabillandcompany.com)

**CRABILL & COMPANY**

(734) 261-8200

33640 Schoolcraft Rd.  
Livonia, MI 48150

**Market Street  
Canton, MI  
19,305 SF  
BUILD TO SUIT**

# **FOR LEASE**

**Building B**



## **Property Highlights**

- 19,305 SF - BUILD TO SUIT
- Zoned Light Industrial
- 1 Dock
- 1 - 12'x14' OHD
- 21.5' Clear Ceiling Height
- 480 - 3 Phase Power
- 400 - 1000 AMPS
- Utilities Ready
- Ample Parking
- 1 Mile from Ann Arbor Rd Exit & I-275
- 1.25 Miles from Ford Rd. Exit & I-275
- Market Street Industrial Park - 4 buildings

For more information, please contact:

**BEN CRABILL III**  
(313) 720-0990

[ben3@crabillandcompany.com](mailto:ben3@crabillandcompany.com)

**CRABILL & COMPANY**

(734) 261-8200

33640 Schoolcraft Rd.

Livonia, MI 48150

Market Street  
Canton, MI  
19,305 SF  
BUILD TO SUIT

# FOR LEASE

## Building B



# SITE PLAN

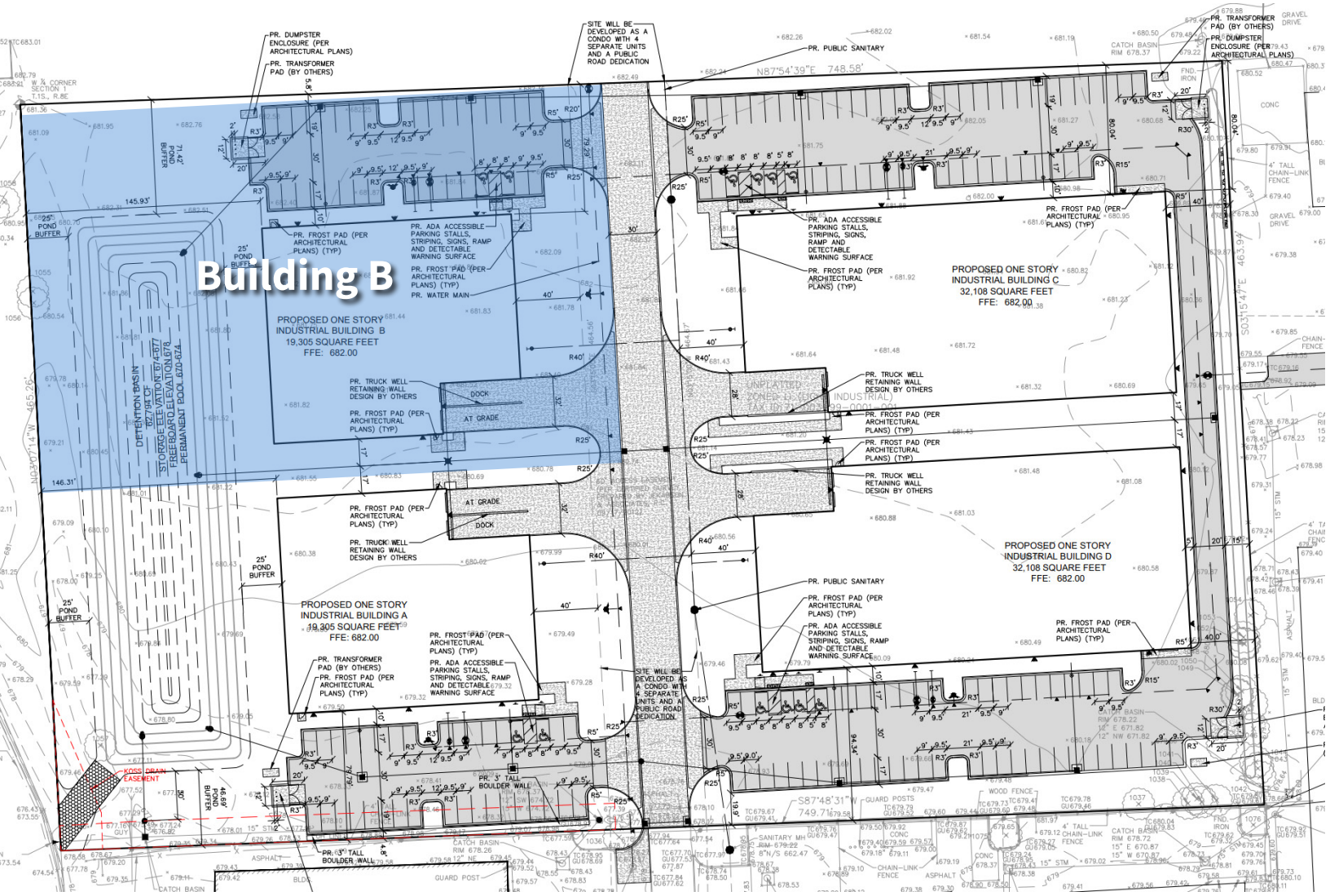

For more information, please contact:

**BEN CRABILL III**  
(313) 720-0990

[ben3@crabillandcompany.com](mailto:ben3@crabillandcompany.com)

**CRABILL & COMPANY**  
(734) 261-8200  
33640 Schoolcraft Rd.  
Livonia, MI 48150

information is subject to verification and no liability or omissions is assumed. Price and terms are subject to change and listing withdrawn without notice.