



# FOR LEASE

705 28th St SW  
Wyoming, MI 49509

1,700-4,300 SF  
Available



## 705 28th St SW Wyoming, MI 49509

### Property Highlights

- Prime High-Traffic Spot on busy 28th St
- Multi-Tenant Retail Building
- High-Growth Opportunity – thriving corridor near Grand Rapids
- Spacious & Versatile – 1,700-4,300 SF Available
- High-demand retail zone
- Basement includes 3,500 SF
- Ample Parking 40 spots in front, side, and rear

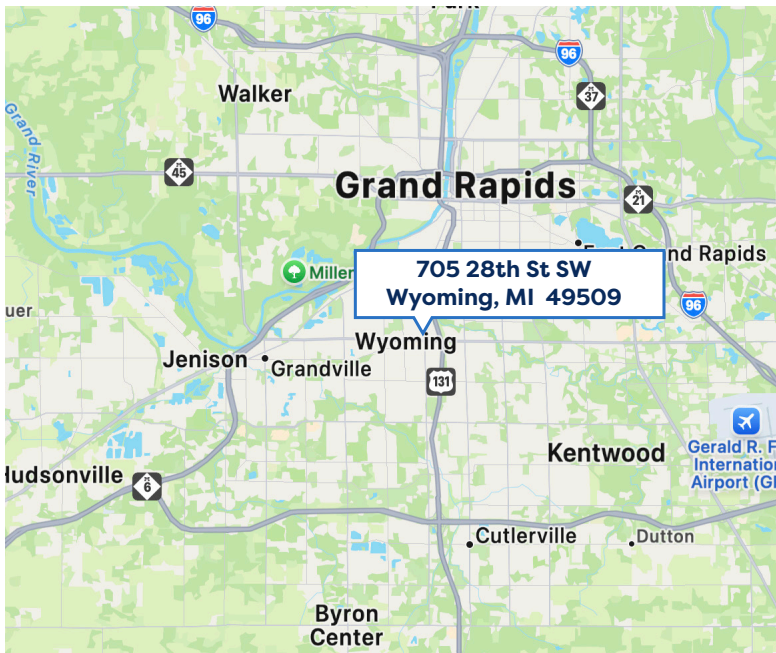

## FOR LEASE \$18 NNN

For more information, please contact:

**RYDER PATTERSON**  
(248) 877-4971  
rpatterson@crabillco.com

**BRIAN CRAWFORD**  
(248) 561-9586  
crawford@crabillco.com

**CRABILL & COMPANY**  
(734) 261-8200  
33640 Schoolcraft Rd.  
Livonia, MI 48150



705 28th St SW, Wyoming, MI 49509  
1,700-4,300 SF Available

**For Lease \$18 SF NNN**



**28TH ST SW**

**28TH ST SW**

**28TH ST SW**

**Rogers Plaza  
Town Center**

**planet  
fitness**

**ALDI**

**O'Reilly  
AUTO PARTS**

For more information, please contact:

**RYDER PATTERSON**  
(248) 877-4971  
rpatterson@crabillco.com

**BRIAN CRAWFORD**  
(248) 561-9586  
crawford@crabillco.com

**CRABILL & COMPANY**  
(734) 261-8200  
33640 Schoolcraft Rd.  
Livonia, MI 48150

**10,700 Total SF**

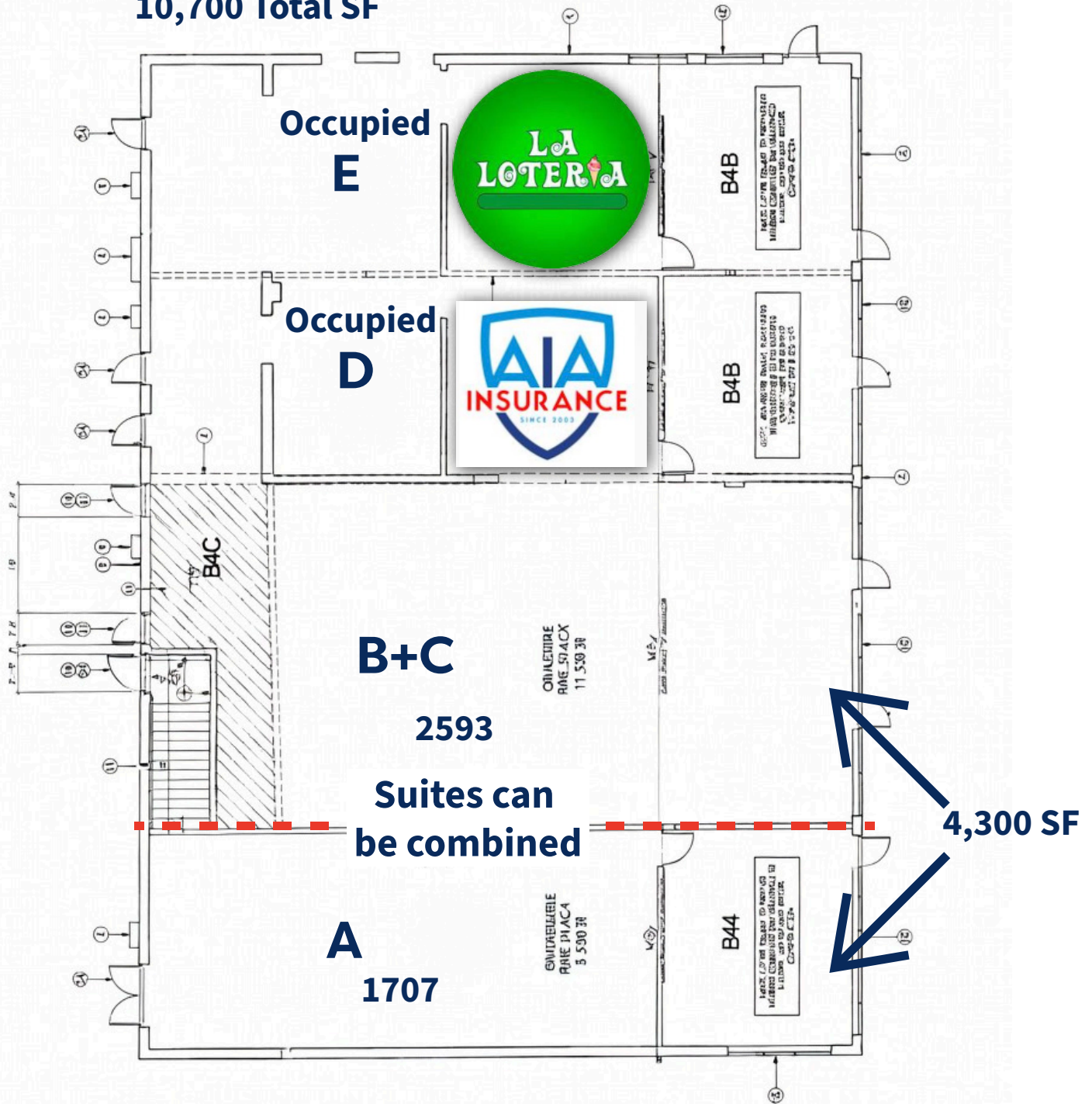

For more information, please contact:

**RYDER PATTERSON**  
 (248) 877-4971  
 rpatterson@crabillco.com

**BRIAN CRAWFORD**  
 (248) 561-9586  
 crawford@crabillco.com

**CRABILL & COMPANY**  
 (734) 261-8200  
 33640 Schoolcraft Rd.  
 Livonia, MI 48150